

THIS COPY IS PROVIDED ON A RESTRICTED BASIS AND IS NOT TO BE USED IN ANY WAY DETRIMENTAL TO THE INTERESTS OF PANDUIT CORP.

PANDUIT PART #	WIRE RANGE AWG [mm <sup>2</sup> ]	TAB SIZE INCH [mm]	HOUSING COLOR	DIMENSIONS in. [mm]	
				L ± .03 [0,8]	MAX WIRE INSULATION DIA.
EDV18-250M	#22-18 [0,5-1,0]	.250 X .032 [6,3 X 0,8]	RED	.98 [24,9]	.154 [3,91]
EDV14-250M	#16-14 [1,5-2,5]		BLUE	.96 [24,3]	.180 [4,57]

NOTES:

- CSA CERTIFIED FOR:
  - STRANDED COPPER WIRE ONLY
  - 221°F (105°C) MAX TEMP RATING
  - 600V MAX VOLTAGE
- MATERIAL:
  - STAMPING: .031" (0.8) THK COPPER, NICKEL PLATED
  - HOUSING: VINYL
- INSTALLATION TOOLS: CT-500, CT-550, CT-1550, CT-1551
- WIRE STRIP LENGTH  $9/32'' \begin{matrix} +1/32 \\ -0 \end{matrix}$  [ 7,1mm  $\begin{matrix} +0.8 \\ -0 \end{matrix}$  ]
- SEE WWW.PANDUIT.COM FOR PACKAGE QUANTITIES INDICATED BY PART NUMBER SUFFIX
- DIMENSIONS IN BRACKETS ARE METRIC EQUIVALENT

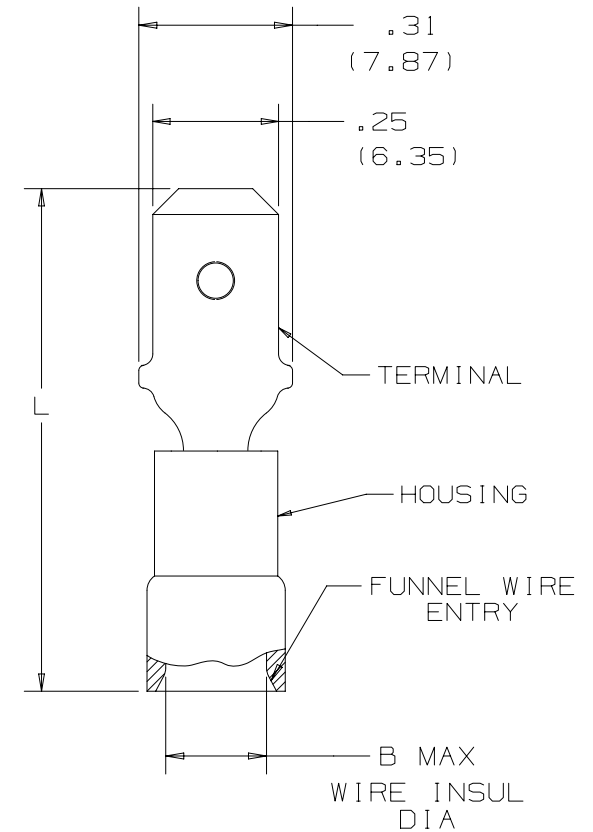

CERTIFIED LR31212

TITLE <b>STRONGHOLD MALE DISCONNECT (250 SERIES)</b> <b>VINYL INSULATED, BRAZED SEAM #22-14 AWG</b> CUSTOMER DRAWING					
ITEM REVISION NAME			00123SHZ/00		
DATASET FILE NAME			00123SHZ/00		
UNLESS OTHERWISE SPECIFIED, DIMENSIONAL TOLERANCES ARE: IN [ mm ] .x ± .1 [ 2.54 ]      .xxx ± .005 [ .127 ] .xx ± .01 [ .25 ]      ANGLES ± 5 °					MATERIAL:  <b>SEE NOTES</b>
DRAWING NUMBER: SH41405					
DRAWN BY	DATE	CHK	SCALE	SIZE	
JHNU	2/18	TMR	NTS	SHT 1 OF 1	A

REV	DATE	BY	CHK	APR	DESCRIPTION	ECN
00	2/18	JHNU	TMR	RGB	RELEASED	00123SH

D10100DA/20